

4018211 206315

4018211 206322

4018211 206339

4018211 206346

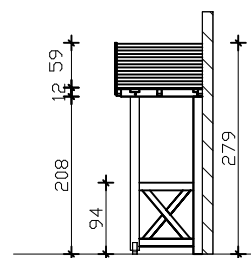
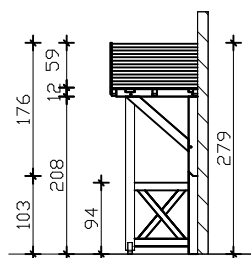
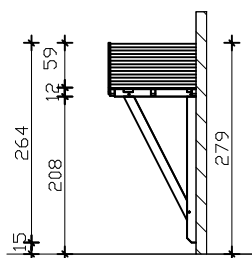
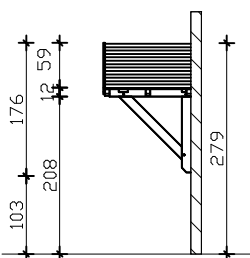

Seitenansichten

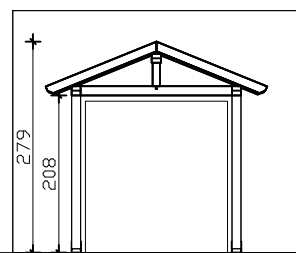
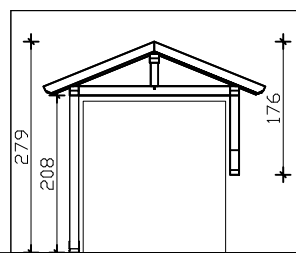
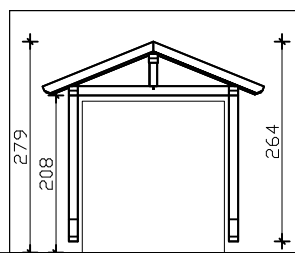
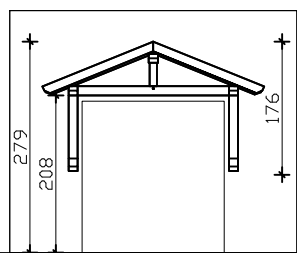

Frontansichten

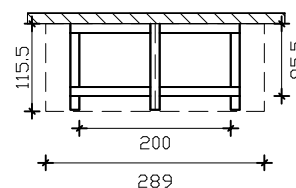
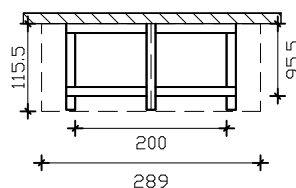
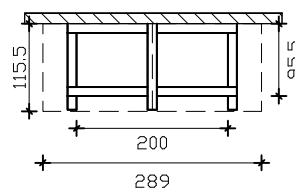
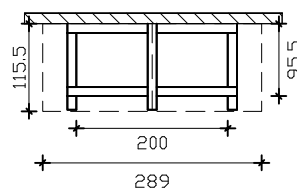

Grundrisse

M 1:100

**Stralsund Vordach Satteldach**  
**Datenblatt / Baubeschreibung**



<b>Holzart / Eisenteile</b>	<b>Nadelholz, unbehandelt / verzinkt</b>
<b>Pfosten / Sparren</b>	<b>12x12cm / 6x12cm</b>
<b>Dacheindeckung</b>	<b>Schalung 2x12cm / Dachneigung 22°</b>
<b>Breite x Tiefe</b>	<b>289cm x 115,5cm (überdachte Fläche)</b>
<b>Höhe / Durchgang</b>	<b>279cm / 208cm (Objekthöhen 176cm / 264cm / 279cm / 279cm)</b>
<b>Verpackungseinheit</b>	<b>B x L x H 112 x 260-310 x 35cm</b>
<b>Gewicht</b>	<b>180kg / 205kg / 210kg / 240kg</b>
<b>Inklusive</b>	<b>Montagematerial, Kopfbänder, Aufbauanleitung</b> (ohne Dübel zur Wandbefestigung, ohne Wandabdichtungsprofile)

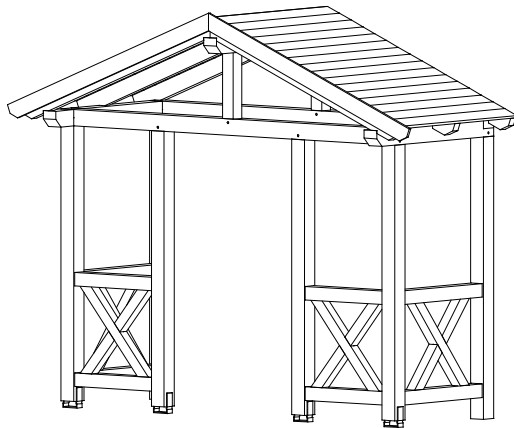

4018211 206353

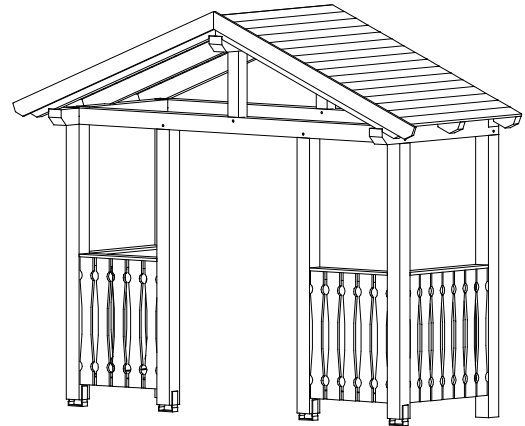

4018211 206360

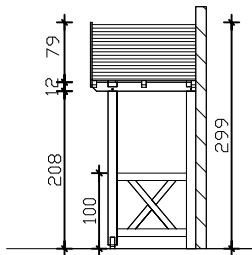

Seitenansichten

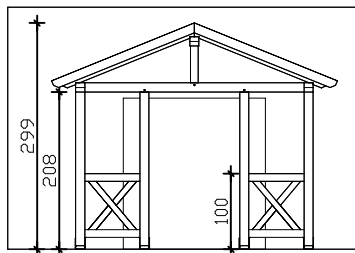
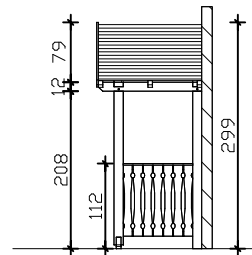

Frontansichten

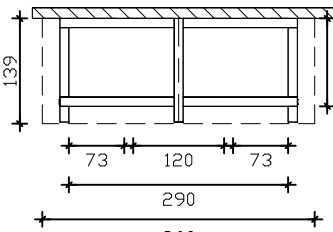
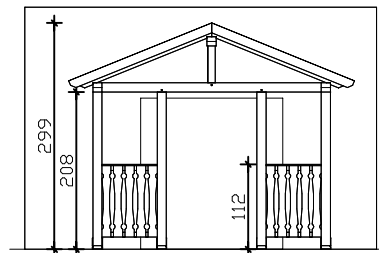

Grundrisse

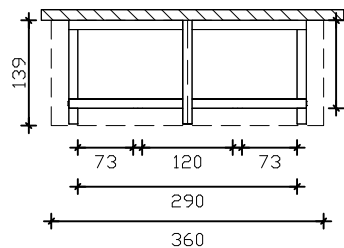

M 1:100

**Stralsund Vordach Satteldach**  
**Datenblatt / Baubeschreibung**



<b>Holzart / Eisenteile</b>	<b>Nadelholz, unbehandelt / verzinkt</b>
<b>Pfosten / Sparren</b>	<b>12x12cm / 6x12cm</b>
<b>Dacheindeckung</b>	<b>Schalung 2x12cm / Dachneigung 22°</b>
<b>Breite x Tiefe</b>	<b>360cm x 139cm (überdachte Fläche)</b>
<b>Höhe / Durchgang</b>	<b>299cm / 208cm (Objekthöhen 299cm / 299cm)</b>
<b>Verpackungseinheit</b>	<b>B x L x H 112 x 365 x 40cm</b>
<b>Gewicht</b>	<b>350kg / 335kg</b>
<b>Inklusive</b>	<b>Montagematerial, Kopfbänder, Aufbauanleitung</b> (ohne Dübel zur Wandbefestigung, ohne Wandabdichtungsprofile)

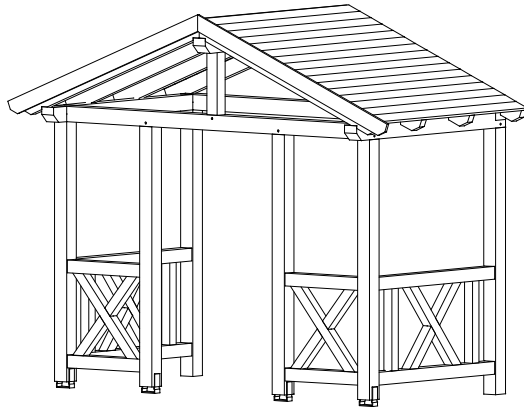

4018211 206377

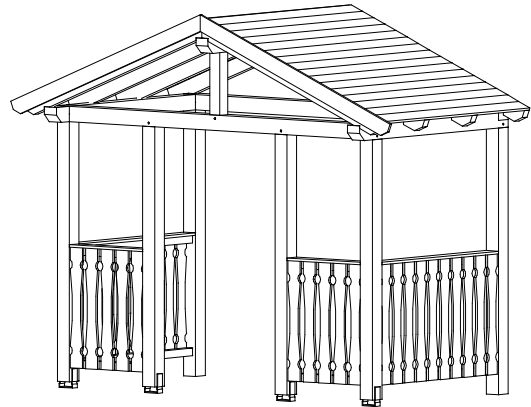

4018211 206384

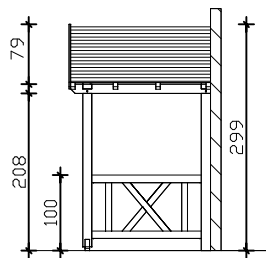

Seitenansichten

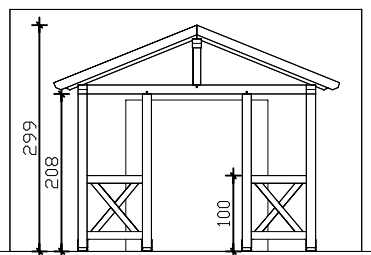
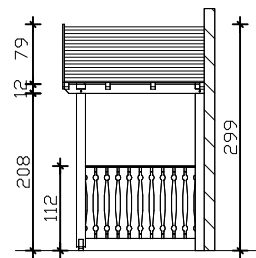

Frontansichten

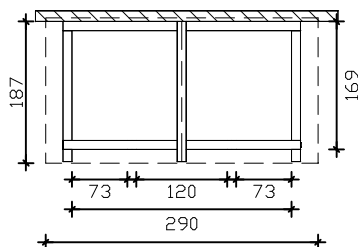
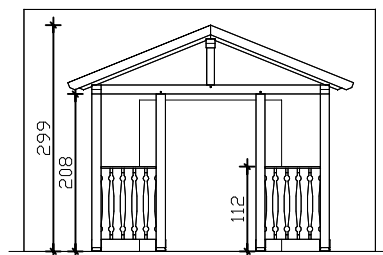

Grundrisse

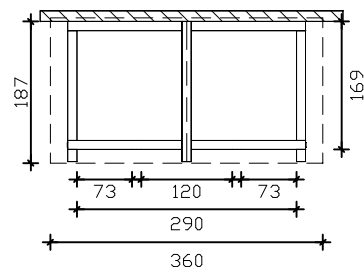

M 1:100

**Stralsund Vordach Satteldach**  
**Datenblatt / Baubeschreibung**



<b>Holzart / Eisenteile</b>	<b>Nadelholz, unbehandelt / verzinkt</b>
<b>Pfosten / Sparren</b>	<b>12x12cm / 6x12cm</b>
<b>Dacheindeckung</b>	<b>Schalung 2x12cm / Dachneigung 22°</b>
<b>Breite x Tiefe</b>	<b>360cm x 187cm (überdachte Fläche)</b>
<b>Höhe / Durchgang</b>	<b>299cm / 208cm (Objekthöhen 299cm / 299cm)</b>
<b>Verpackungseinheit</b>	<b>B x L x H 112 x 365 x 50cm</b>
<b>Gewicht</b>	<b>415kg / 355kg</b>
<b>Inklusive</b>	<b>Montagematerial, Kopfbänder, Aufbauanleitung</b> (ohne Dübel zur Wandbefestigung, ohne Wandabdichtungsprofile)