

# OPERATOR'S MANUAL

RABACONDA

RABACONDA

## STREET BIKE TIRE CHANGER

EN-US 2025/2

## COLOPHON

### Addresses:

#### Postal address:

RABAConDA OÜ  
Tihniku 2  
Pärnu 80034  
Estonia

#### Internet address:

[rabaconda.com](http://rabaconda.com)

#### E-mail address for technical support:

[support@rabaconda.com](mailto:support@rabaconda.com)

#### Phone:

(USA) 1-646-933-1298  
(Europe) +44 7960 246 838

#### Manual info:

These are the original instructions. The English language is binding. No part of this documentation may be reproduced without the written permission of Rabaconda®.

## Table of Contents

<b>1</b>	<b>Preface.....</b>	<b>5</b>
1.1	Identification .....	5
1.2	Features .....	5
1.2.1	Significant advantages of the Rabaconda® Street Bike Tire Changer.....	5
<b>2</b>	<b>Warranty Upon Purchase.....</b>	<b>6</b>
<b>3</b>	<b>Introduction.....</b>	<b>6</b>
3.1	Explanation of Documentation .....	6
3.2	List of Abbreviations.....	7
3.3	Safety Warning Messages in this Manual.....	7
3.4	Intended Users .....	7
3.5	Intended Use.....	8
3.6	Unintended Use .....	8
3.7	Tools and accessories .....	8
3.8	What is in the box .....	9
<b>4</b>	<b>Safety.....</b>	<b>12</b>
4.1	Introduction .....	12
4.2	Generally Applicable Safety Rules .....	12
4.3	Personal Protective Equipment.....	12
4.4	IMPORTANT SAFETY RULES FOR THIS TIRE CHANGER.....	13
4.5	General Safety Rules for Tools.....	13
<b>5</b>	<b>Operation Instructions.....</b>	<b>14</b>
5.1	Warnings and Rules for Safe Operation .....	14
5.2	Prepare for assembling .....	14
5.3	Human.....	14
5.4	Operator.....	14
5.5	Workplace .....	15
5.6	Assembling the tool .....	15
5.6.1	Assembling Preparation .....	15
5.6.2	Assembling.....	16
5.7	Prepare for operation.....	17
5.8	Dismount a tire.....	18
5.9	Mount a tire .....	26
<b>6</b>	<b>Maintenance and repair.....</b>	<b>29</b>
6.1	Preventive Maintenance .....	29
6.2	Ordering Parts .....	30

6.3	Packing, Transport and Storage.....	31
<b>7</b>	<b>Spare parts and wearing parts.....</b>	<b>32</b>
7.1	Wearing Parts.....	32
7.2	List of Consumables .....	32
<b>8</b>	<b>Specifications.....</b>	<b>32</b>
<b>9</b>	<b>FAQ.....</b>	<b>33</b>
<b>10</b>	<b>Warranty.....</b>	<b>34</b>
10.1	Warranty Provisions .....	34
10.2	LIMITED WARRANTY .....	34
10.3	Liability.....	35

**CHANGE YOUR OWN TIRES FAST,  
EASILY, AND EFFICIENTLY.**

## 1 PREFACE

### 1.1 Identification

The Rabaconda® Street Bike Tire Changer (Patent Pending) is a nifty, advanced, efficient tire changing tool for street motorcycles. Motorcyclists can easily use it at home, service technicians can use it in workshops or events. The tool allows you to change tires quickly, easily, and efficiently.

In the beginning, it takes some practice to work with it properly. It is a sophisticated tool that requires some experience. Give yourself time to gain this experience by changing a few tires. If you still have problems, contact our Technical Support.

### 1.2 Features:

- Easy to carry.
- Lightweight, taking very little room in your garage.
- Store it away on a shelf until you need it again.
- Strong carry-bag for comfortable travel and compact storage.
- Can be set up within seconds, garage or trackside.
- Innovative frame design with unparalleled stability at low weight.
- Wide leg stance for excellent balance.
- A plastic mounting head reduces the risk of scratching the rim with tire irons.
- Long lever for breaking even the most challenging beads.
- Oval-shaped operating handle with good grip.
- Quickly adapted to different wheel sizes.
- Lifetime Warranty.
- Free shipping in US and EU.
- 6 Months Money-Back Guarantee.

#### 1.2.1 Significant advantages of the Rabaconda® Street Bike Tire Changer

- This Tire Changer helps you use your tires strategically; Switch to correct tires for the occasion you're in every time you hit the track.
- Empowers you to change your tires whenever and wherever you need to.
- The tool helps you regain control; no more pestering your mechanic friends for help.
- It saves you a lot of money on dealer tire changes in the long run.
- This tool saves time traveling to the dealership and back (rather spend it riding instead!).
- It allows you to buy whatever tires you want, wherever you get the best price.
- Eliminate busted knuckles and back pain. No 5-gallon buckets come with the territory when trying to change your tires the oldway.
- The tool helps you break the tire bead without damaging or scratching the rims.

## 2 WARRANTY UPON PURCHASE

(See also Chapter 10).

### Lifetime Warranty

Lifetime warranty for manufacturer defects.

### Money-back guarantee

All Rabaconda® products have a money-back guarantee if you are unhappy with our tools, no questions asked. You have six months to test and become familiar with our products. Take your time!

## 3 INTRODUCTION

The Rabaconda® Street Bike Tire Changer is designed for cast, forged and spoked wheels. The tool offers additional rim protection. It is adaptable to any wheel size between 12" - 21" and has excellent ergonomics and low weight. It works on front wheels and on both single-sided and double-sided swingarm rear wheels. With Rabaconda®, you can swap your tires in no time, whether riding the street or hitting the track.

### Read this Operator's Manual before operating the Tire Changer



- Pay special attention to safety precautions presented in this manual, as they prevent accidents causing wheel or tool damage or human injury.
- This tool can be dangerous. Therefore, reading this manual and watching tutorial videos on our website before the operation is essential.
- This manual describes characteristics unique to the Rabaconda® Street Bike Tire Changer.
- In this manual, safety is a priority. By reading it, you will become aware of the dangers and hazards of operating this tool.

### Using This Manual

This Operator's Manual is created to help familiarize you with Safety, Assembly, Operation, Adjustments, Maintenance and Troubleshooting. The information contained within this manual was current at the time of printing. Some parts may change slightly to assure you of the best performance. To check for updates, refer to our website or call us to speak to one of our representatives.

### 3.1 Explanation of Documentation

Chapter 3; 'Introduction' and Chapter 4, 'Safety' is essential for anyone working on the device. For operators is essential:

- Chapter 5; Assembling and Operation Instructions.
- Chapter 8; Maintenance.

### 3.2 List of Abbreviations

- CE: Conformité Européenne.

### 3.3 Safety Warning Messages in this Manual

Read this manual carefully before using the Tire Changer to understand how to use it correctly. If there is something in this manual you don't understand, ask Tech support to explain it.

- After reading, store the manual in a safe place, easily accessible for everyone working with the tool.
- Incorrect handling of the equipment could result in personal injury or physical damage.
- The manufacturer assumes no responsibility for any damage caused by mishandling beyond normal usage defined in this Operator's manual.

#### DANGER!



**This symbol indicates a potentially hazardous situation that, if not avoided, could result in death or severe injury, or machine damage.**  
This RED symbol indicates All WARNING notifications.

#### WARNING!!



**This symbol indicates a potentially and imminently hazardous situation that, if not avoided, will result in death or severe injury.**  
This ORANGE symbol indicates All DANGER notifications.

#### CAUTION!



**This symbol indicates a potentially hazardous situation that, if not avoided, may result in minor or moderate injury.**  
This YELLOW symbol indicates All CAUTION notifications.

#### NOTICE!



**This Notice symbol shows special procedures or points out essential facts.**

Always adhere to the recommendations and warnings in this manual. They are the recommendations of Rabaconda®. If you ignore these recommendations, there will be no warranty.

### 3.4 Intended Users

Intended users are technically skilled Motorcycle Drivers or Motorcycle Technicians.



### 3.5 Intended Use

The Street Bike Tire Changer is intended for use as a tool for removing and installing motorcycle tires.

### 3.6 Unintended Use

Unintentional use is any other use than described under 'Intended use.'

### 3.7 Tools and accessories

- Tire changer carry bag
- Standard Duck Head
- 16" Street Bike Tire Iron
- 15mm Spindle Kit.
- Drop Center Tools for stiff sidewall tires
- Plastic protector for 16" Street Bike Tire Iron
- Strap for wire-spoke wheels
- Adaptors for various wheel hub dimensions (single-sided swingarm wheel hubs, etc). Optional.
- Duck head for Cross-Spoked Rims (like on BMW GS, Triumph Scrambler, Triumph Tiger, Moto Guzzi V85, etc.) Optional.
- Bead Grease Tire Mounting Lubricant (1kg/2.2lbs) Optional.
- Bead Grease Brush. Optional.
- Valve Core Tool. Optional.
- Beadpal Tire Mounting Tool. Optional.
- Tire Changer Shop Mat. Optional.
- Other tools.

The list of tools and accessories evolves over time to give customers best possible experience with the Street Bike Tire Changer.

### 3.8 What is included

The tool comes in a cardboard box.

The following parts are in the box. Check the content.

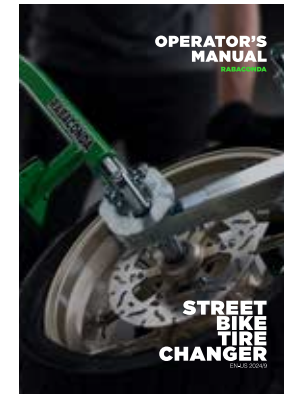

Operator's Manual



Rabaconda Carry bag

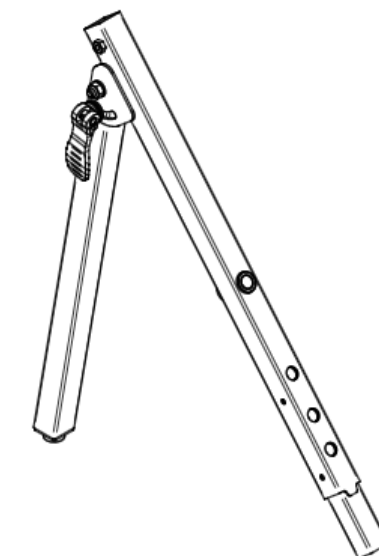

Main stand with rear leg

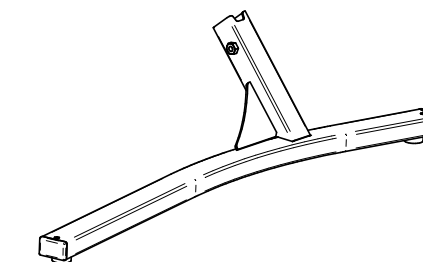

Base leg of the stand

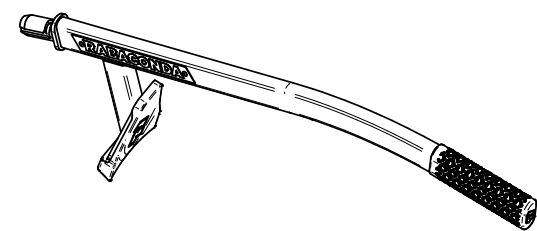

Multi-functional Bead breaker handle with plastic cover

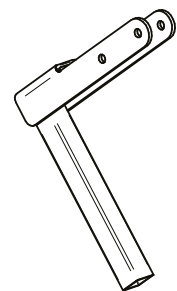

Bead breaker bracket

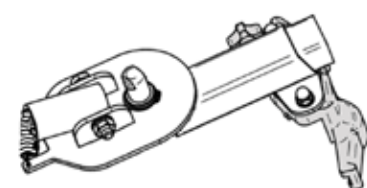

Duck head ratchet system with mounting/dismounting arm; Duck head



Rim rotation blocker (stopper pin)



Tire iron and protective plastic cover

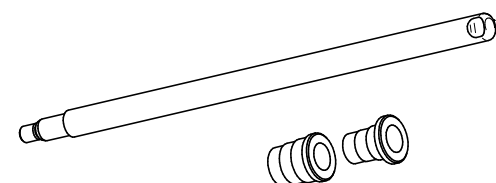

20mm center spindle  
Stepped bushings 22-25mm  
Stepped bushing 28-32mm

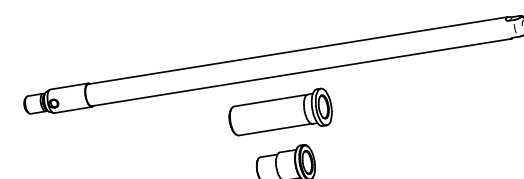

15mm center spindle  
Ratchet system bushing (black)  
Stepped bushing 17mm-3/4"

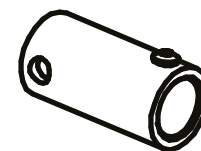

Bead breaker socket



Bead breaker knob screw



Bead breaker knob nut



Strap for wire-spoked wheels



Quick-release screws, 2pcs



Magnetic wheel supports, 2pcs



Drop center tool, 2pcs

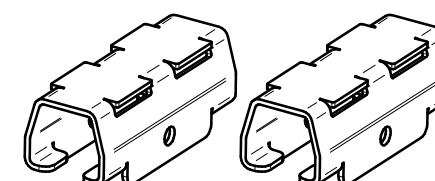

Wheel support riser clamps, 2pcs

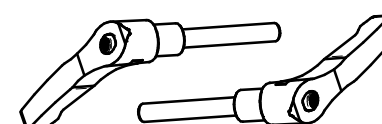

Riser clamp screws, 2pcs

## 4 SAFETY

### WARNINGS!



- READ AND UNDERSTAND ALL SAFETY MEASURES AND WARNINGS BEFORE STARTING ANY OPERATION OR ADJUSTMENTS.
- UNTRAINED PERSONS WHO HAVE NOT THOROUGHLY READ AND UNDERSTOOD THIS MANUAL MIGHT NEVER APPROACH THE DEVICE.
- DO NOT TRY TO USE TIRES WITH A BIB MOUSSE INSERT WITH THIS MACHINE, AS THIS CAN LEAD TO DAMAGING THE TIRE CHANGER.
- USING EXCESSIVE FORCE SHOULD BE AVOIDED AT ALL TIMES AS IT CAN LEAD TO PERSONAL INJURY OR DAMAGE TO THE WHEEL OR THE TIRE CHANGER.

### 4.1 Introduction

The machine design is such that safe use is possible. Anyone who works with it must know the instructions and regulations stated in this manual.

The owner ensures that users know the instructions, operating regulations, and observations.

### 4.2 Generally Applicable Safety Rules

This list contains general safety measures which must be complied with for personal safety reasons.

- Make sure children and animals cannot come into the machine's vicinity.
- Only persons who have read and understood the operating instructions might be in the machine's vicinity.
- Unauthorized persons may not perform acts if the machine is in use.
- Do not remove the warning decals, stickers, or markings.
- Always clean the machine properly and keep the workplace free of dirt and obstacles.
- Always ensure sufficient ambient lighting.

### 4.3 Personal Protective Equipment



While handling, assembling, and maintaining the Tire Changer, adhering to all recommended safety instructions and ensuring that the correct Personal Protective Equipment (PPE) is used.

#### Always wear:

- Safety gloves; for hand protection and prevention of cuts from sharp edges.
- Steel-tipped safety boots; for foot protection from falling objects.
- Safety glasses for eye protection and prevent damage caused by shooting particles.
- Any other Personal Protection Clothing or Equipment that is required, specified, or dictated by the working environment.
- Your Company can prescribe additional (safety) instructions. This Manual does not describe how to comply with this.

### 4.4 Important Safety Rules for this Tire Changer

- The operator should be familiar with all functions of the device.
- Persons under 16 should NEVER operate the tool.
- Do not operate the device for any purpose other than what it is meant for. (See warranty for details.)
- Visually inspect the tool; check all fasteners and securing parts.
- Take time to learn proper techniques and never use excessive force to stretch a tire on or off a wheel.
- It takes practice, experience and extra caution to change tires on carbon, custom alloy, or aluminum wheels and high-performance low profile tires. Ensure the mounting/demounting head is not damaged where it makes contact with the rim, as a scratched mounting / demounting head can damage the rim finishing.
- Work behind the tire changer when operating the ratchet system handle, not in front.
- Turn the ratchet socket opening towards you before inserting the handle/lever.
- Take your time to learn the proper technique and allow yourself a few tire changes to master the tool.
- Never use excessive force.
- Always ensure the tire is in the drop center from the opposite side when mounting/ dismounting the tire.
- When changing stiff sidewall tires, warm up the tire before mounting.
- Always clean wheels from dirt and debris to avoid scratches on the rim and to the plastic parts of the tire changer.
- If the duck head's inner surface becomes scratched, then the duck head will start damaging the surface on the following rims. Replace the parts if any noticeable damage, that could harm the rim or tire, is detected.

### 4.5 General Safety Rules for Tools

- Incorrect practice or lack of care can cause wounds, mutilation, suffocation, and other bodily injuries.
- Ensure the work area around the equipment is smooth, clean and free from any obstacles. Keep in mind that a dangerous situation can always arise.
- Always wear safety glasses and protective shoes when carrying out the operation.
- Always use tools that are in a good state of repair. Ensure you know how to use the tools before doing any work.
- ONLY use replacement parts from the same brand as the relevant part.
- Do not use a tool if you are tired or consume alcohol or drugs, affecting your ability to work perfectly.
- Parts that rotate can cause cuts, mutilations or strangulation.

#### Not Allowed Use

It is not allowed to use the Rabaconda® Tire Changer for other than motorcycle tire changing activities.

## 5 OPERATION INSTRUCTIONS

### 5.1 Warnings and Rules for Safe Operation

#### WARNING!



- Persons under 16 should not operate the Street Bike Tire Changer.
- Ensure you understand all procedures for assembling and operating the Tire Changer.
- Never operate the Street Bike Tire Changer while under the influence of drugs or alcohol.
- DO NOT operate the Tire Changer for anything other than what it is meant for.
- During the bead-breaking operation, stay balanced on both feet at any time when using the device, avoid losing your balance and be cautious not to cause any injuries.
- Do not use the stopper pin on wire-spoked wheels as you may damage the spokes. Use the strap.
- Ensure the wheel entirely rests on both wheel support blocks. Otherwise, you will destroy (bend) the center spindle.
- During tire mounting/dismounting, ensure that the tire falls into the drop center from the opposite side of the duck head by using drop center tools or by pushing it down with your hands.
- Always use bead grease when mounting and dismounting a tire.
- After locking the tire iron under the ratchet hook and rotating, hold the tire iron so it does not fall and scratch rims.
- Any excessive force trying to force the tire on or off the rim considerably raises the risk of severe personal injury or damage to the rim, the tire, or the tire changer.

### 5.2 Prepare for assembling

- Ensure all parts are present.
- Adhere to PPE safety regulations as described in the manual.

### 5.3 Human

An operator makes the Tire Changer ready for use and starts it as described further in this chapter.

### 5.4 Operator

Every well-skilled technical person over 16 can act as an operator. For safely using this Street Bike Tire Changer, the operator must have the following specific professional knowledge:

- General knowledge of industrial safety procedures.
- Basic knowledge and skills regarding motorcycle service equipment.
- Basic knowledge and skills regarding motorcycle tire change principles and processes.

### 5.5 Workplace

To change a tire, you need a minimum distance of 1 m around the device to assemble, remove, and install a tire.

### 5.6 Assembling the tool

#### WARNING!



- Read and understand all instructions before assembling the Tire Changer.
- If possible, watch tutorial videos via our website.

#### 5.6.1 Assembling Preparation

- Inspect the whole tool-set visually and check all vital components for damage.
- Check that the working area is relatively smooth and free of obstacles.
- Assemble the tool on a protective floor cover.
- Keep animals far away from the workplace.
- Fit the parts together, as shown in the figure of 5.6.2



## 5.6.2 Assembling

Fit the parts together, as shown in the figure.

1. Insert the base leg of the stand to the main stand and fasten with a quick release screw.
2. Fasten the main stand's rear leg firmly by the quick release cam lever to avoid collapsing during operation.
3. Mount the center spindle to the main stand.
4. Attach magnetic wheel supports to the main stand.
5. Attach the L-shaped bead braker handle socket to the main stand and fix with quick release screw. Assemble the Bead Breaker Handle socket using the provided knob fasteners.
6. Insert the operating lever fully and properly into the bead braker handle socket.
7. Keep the stepped bushing and ratchet system at hand to mount over the center spindle when advancing to corresponding phase.
8. Keep the rim rotation blocking pin at hand for when advancing to corresponding phase.

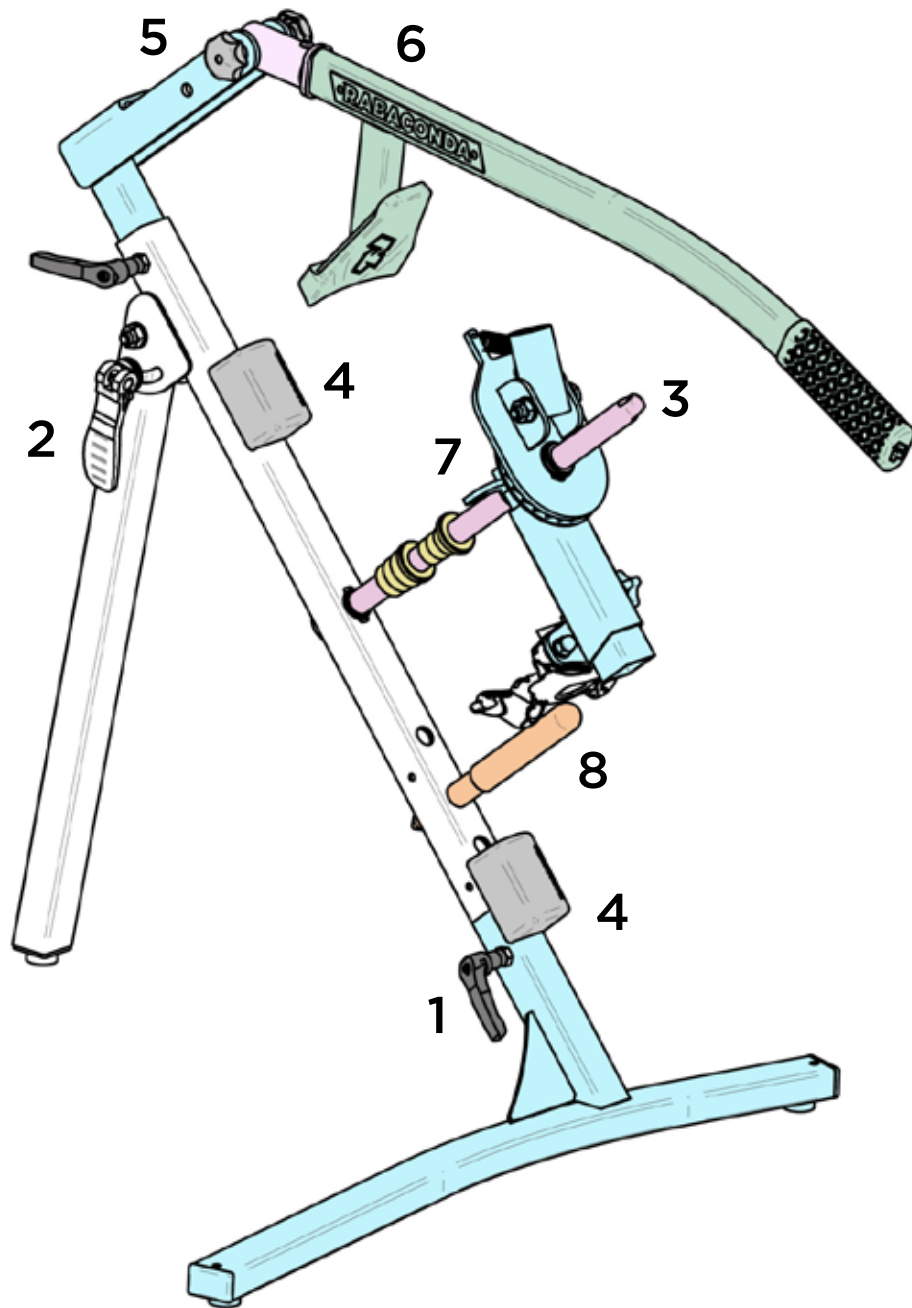

## 5.7 Prepare for operation

- Clean the wheel from dirt and debris to avoid scratches on the rim and to the plastic parts of the tire changer.
- Inspect the duck head, wheel supports, bead breaker cover, stopper pin, and strap closely for any damage. Replace the parts if any noticeable damage that could harm the rim or tire is detected.
- All parts of the tire changer that will get or might get in contact with the wheel must be clean. Swipe off all dirt and debris.
- Position the wheel supports blocks to match the diameter of the rim to avoid damage to the rim, brake discs, or tire changer.
- Ensure you read this manual thoroughly.
- Use the center spindle and stepped bushing for placing the wheel on the tool frame.
- When changing stiff sidewall tires, ensure to warm them before installing, use plenty of bead grease and more drop center tools.
- Ensure you choose the correct pivot point for the bead breaker socket. You can set it for narrow tires (1) or wide tires (2).
- Use the 15mm spindle (3) for 15mm - 3/4" diameter wheel hubs. **The black plastic spacer (4) must be mounted to the ratchet system center.** Always use the stepped bushing (5) if possible.

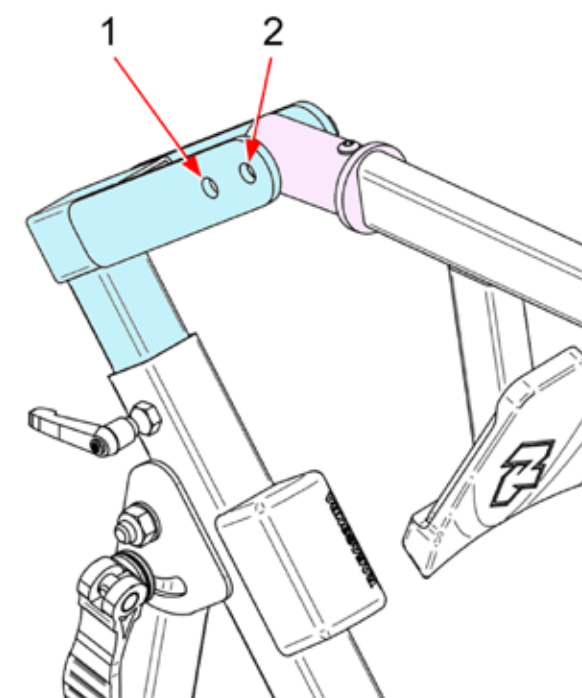

Bead breaker socket positions

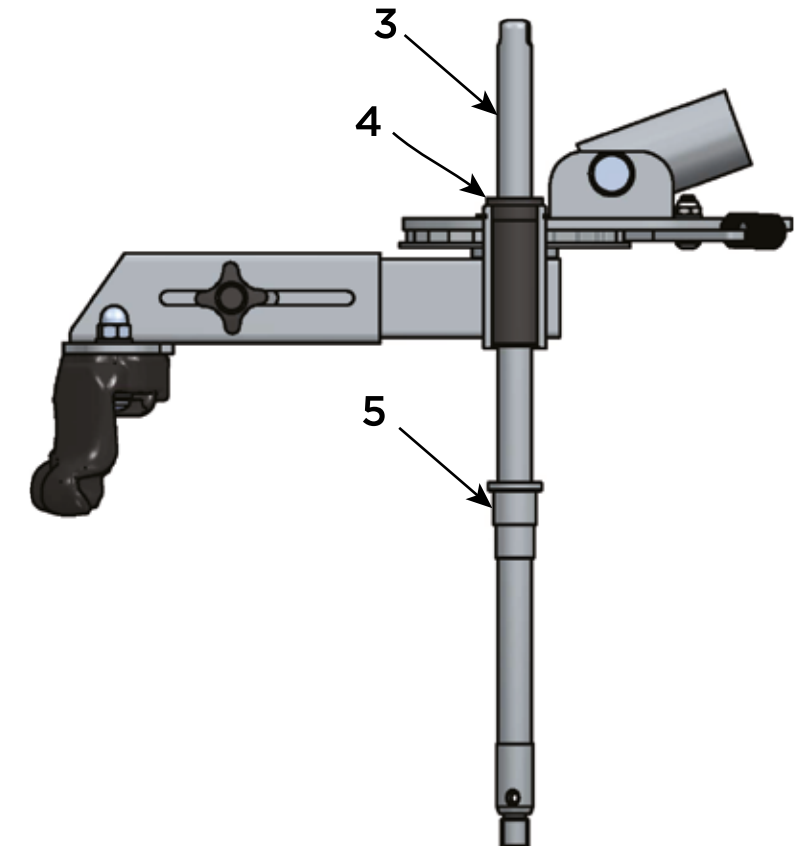

15mm spindle kit assembly

- Wheel Support Riser Clamps must be used when the width of the wheel hub will not allow the rim to reach the plastic wheel support pads. This is often the case with rear wheels with sprockets and belt pulleys. The use of clamps will prevent damage to the center spindle and allow for normal operation of the tire changer.

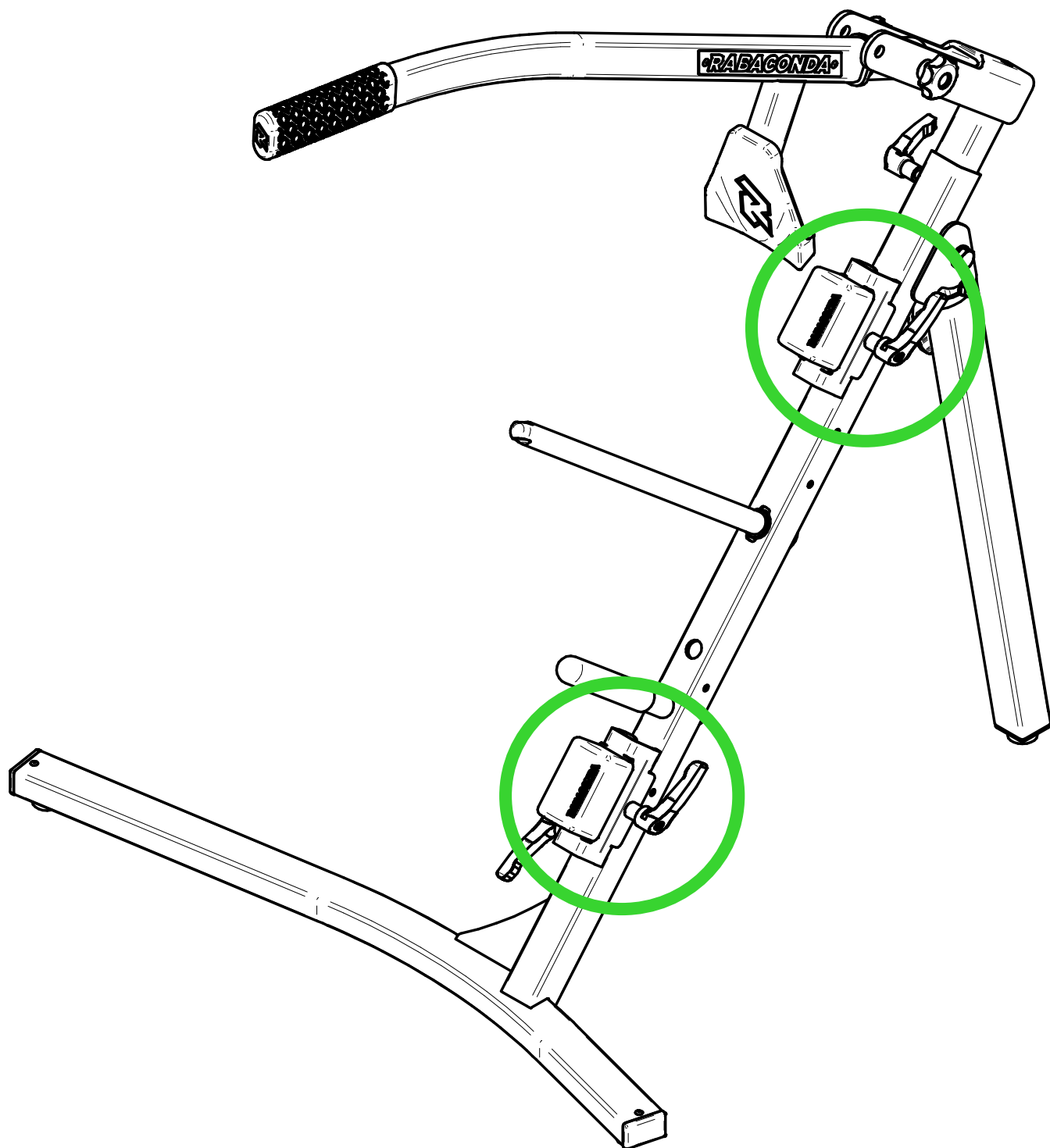

#### Assembly instructions

1. Mount the quick release screw (1) to the riser clamp (2).
2. Attach the magnetic wheel support pad (3) to the clamp (2).
3. Mount the clamp assembly to the main frame of the tire changer, position it under the rim, and tighten the screw (1). Adjust the screw handle angle if needed by pulling it out and rotating.

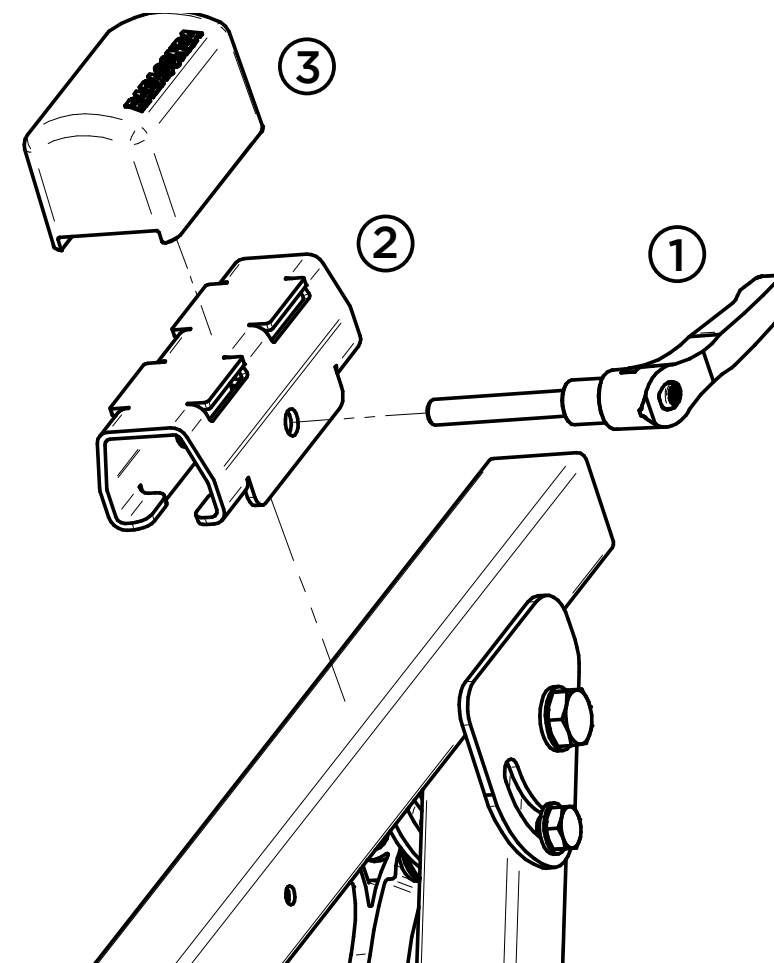

## 5.8 Dismounting a tire

We recommend you also watch the tire change tutorial video.  
Scan the code with your phone camera or go to [rabaconda.com/start](https://rabaconda.com/start)

**1. Clean the wheel from dirt and debris to avoid scratching the rim and plastic parts of the tire changer.**

**2. Place the wheel on the tool**



- Place the tool on a flat surface.
- Insert the center spindle into the tool.
- Place the wheel on the center spindle.
- Move the wheel supports blocks in the position to support the wheel from below.

### NOTICE



Universal Big Hub Adapter (32-68mm) and BMW Shaft Drive Type Adapter need to be mounted on the wheel hub before placing it on the center spindle.

**3. Minimize free play between the wheel and spindle**



- To minimize free play, place the stepped bushing or appropriate adapter (sold as optional accessories) over the spindle, into the wheel hub.

**SCAN TO START**



**4. Adjust the Bead breaker**



- Please note there are two positions for the bead breaker socket, one for wider and one for narrower rims. Choose an appropriate position to have the bead breaker handle at effective working height.
- Insert the bead breaker handle and rotate 90° to engage the safety lock.
- Adjust the bead breaker to match the wheel diameter and width. Ensure the bead breaker is close to the rim but does not get in contact with the rim. Secure the sliding part with the quick-release screw.

**5. Break the bead on both sides**



- Use the bead breaker to break the bead.
- Rotate the wheel in small steps and break the bead until the first bead is entirely pushed off the rim.
- Turn the bead breaker handle up.
- Flip the wheel onto its other side.
- Break the bead from the other side of the rim.

**6. Install the mounting/dismounting arm with duck head**



- **Spray liquid tire mounting spray or soapy water on the tire bead all around the tire.**
- Mount the duck head on the center spindle at the 12 o'clock position (top).
- If needed, push the tire down with the bead breaker for easier installation.
- If the wheel has a tire pressure monitoring sensor (TPMS), position the sensor at 9 o'clock while the duck head is mounted at 12 o'clock position.



## 7. Lock the mounting/dismounting arm position



- Fix the duck head position by tightening the knob screw on the duck head arm.

### NOTICE



Different duck head is needed for cross-spoked rims where spokes run out to the sides of the rim (like on BMW GS, Triumph Scrambler, Triumph Tiger, Moto Guzzi V85, etc.), where the side of the rim is thicker due to spoke placement and standard duck head will not fit. It is sold as optional accessory.

## 8. Position the duck head at 6 o'clock position



- Rotate the wheel to have the duck head at 6 o'clock position. This is the best starting position.
- The valve (TPMS) should now be located at around the 3 o'clock position.

## 9. Block the wheel rotation



- Insert the wheel rotation blocker (stopper pin) into the lowest possible hole on the frame to block the wheel from rotating.

### CAUTION!



Always insert the stopper pin to the lowest hole possible. Otherwise, you risk damaging the rim or the tire changer.

### NOTICE



Do not use the stopper pin and use the strap instead if:

- You cannot install the stopper pin properly due to specific wheel construction (blade-type wheel design, etc);
- The metal pin is too short to reach the rim;
- Brake discs or transmission parts do not allow the installation of the stopper pin.



- Under no circumstances, do not use any other object to replace the provided stopper pin. Using a longer pin will damage the tire changer frame;
- Never use the stopper pin with wire-spoked wheels;
- The strap should remain behind the rim to prevent Duck head obstruction.



## 10. Use of the supplied strap



- Position the strap around a spoke as close as possible to the rim, set at 5 o'clock, and on the spoke, which direction is most aligned with the strap direction to avoid damage to the spoke.



- Pass the strap under the base leg and tighten it.

## 11. Lift the tire over the duck head



- Insert the Tire iron between the tire and the extending portion of the duck head.

## WARNING!



- Always avoid excessive force as it can damage spokes or the tire changer.
- Always use sufficient amount of liquid lubricant when dismounting a tire.



- Use the bead breaker to push down the tire into the drop center at the opposite side of the duck head.
- Simultaneously lift the tire over the duck head with the tire iron.



- Lock the Tire iron under the hook attached to the ratchet system.

## 12. Insert the Bead breaker handle to the Ratchet system socket



- Position ratchet system socket to face the 9 o'clock position.
- Insert the Bead breaker handle into the Ratchet system socket.
- **Always stand behind the tire changer when operating the ratchet system.**

### WARNING!



- Ensure the wheel entirely rests on both wheel support blocks. Otherwise, you will damage (bend) the center spindle.
- Ensure that the bead breaker lever is fully inserted into the Ratchet system socket.

### NOTICE



During the entire dismounting process, ensure that the tire is in the drop center of the rim, opposite the position where the duck head works.

## 13. Operate the Duck head



- Push the bead breaker handle down to rotate the duck head around the rim. Bring the handle back to its initial position and repeat.
- Hold the tire iron with one hand until it can be released.
- Rotate the duck head around the rim until the first bead of the tire is completely dismounted.

## 14. Dismount the second bead



- Follow the same process to dismount the second bead.
- Rotate the duck head to 6 o'clock position, use the tire iron to lift the second bead over the duck head extending portion. Lift the tire to the drop center at the top for easier tire iron insertion.
- Insert the bead breaker handle and rotate the duck head around the rim until the second bead is entirely dismounted.



## 5.9 Mounting a tire

### NOTICE



- ENSURE DURING THE MOUNTING PROCESSES THAT THE TIRE IS IN THE DROP CENTER OF THE RIM FROM OPPOSITE WHERE THE DUCK HEAD IS OPERATING.
- Always start by applying sufficient amount of bead grease to the tire bead on both sides.
- Check if the tire has a directional rotation indication and align accordingly on the rim.
- Use multiple drop center tools on stiff sidewall tires to force the tire into the drop center from opposite where the mounting/dismounting head is operating.
- Always warm up a stiff sidewall tire before installing.

### 1. Mount the first bead of the tire



- Place the duck head at 12 o'clock position.
- Mount the first bead of the tire over the duck head diagonally so that the extending knob portion of the duck head is visible, while the left portion of the duck head is under the bead.
- Push the right side of the tire on the rim with your hands as much as possible.



- Insert the bead breaker handle and operate the duck head until the first bead of the tire is fully mounted. Stop at 12 o'clock position.

### 2. Mount the second bead



- Ensure the duck head is in a 12 o'clock position.
- Mount the second bead over the duck head diagonally so that the extending portion of the duck head is visible, while the left portion of the duck head is hidden under the tire bead.

### NOTICE



- For stiff sidewall tires use one or two Drop center tools to force the tire into drop center from opposite where the mounting head is operating. See Step 3 on the next page.
- If you don't have Drop center tools, then use either your hands, a tire iron, wooden blocks or other suitable objects to guide the tire to the drop center as much as possible.



- Insert the bead breaker handle and operate the ratchet system until reaching moderate resistance.
- Using your hands, push the mounted part of the tire at the top side into the drop center.
- If needed (for stiff side wall tires), temporarily use the bead breaker to further force the tire into the drop center.
- Operate the duck head till the tire is completely mounted on the rim.

### 3. Mounting stiff sidewall tires with Drop center tools



- Mounting stiff sidewall tires requires extra care, patience, caution, and the use of Drop center tools. The warmer the tire, the easier it is to mount.
- Add some bead grease to the Drop center tool (1) and install it at 2 o'clock.
- Operate the ratchet until the 10 o'clock position.
- Apply bead grease on second Drop center tool (2) and place it at 10 o'clock as shown.
- Operate the Duck head and make sure that the tire slides into the drop center of the rim.
- Operate the ratchet until the tire is completely mounted on the rim.
- Remove the Drop center tools.
- If needed, use the bead breaker to push the tire over the duck head.
- Remove the duck head ratchet system. If needed, use the bead breaker to help removing the duck head from the rim.



## 6 MAINTENANCE AND REPAIR

This manual describes periodic maintenance that the owner can do.

### GENERAL WARNINGS FOR MAINTENANCE:



- Always perform maintenance on a level and solid surface in a well-lit, clean and dry area.
- Keep all parts of the tool clean to ensure all parts fit together without problems. Dirty parts lead to damage and poor fitting.
- Provide adequate protection around moving or rotating parts, paying attention to the risk of pinching.
- Only use genuine or equivalent parts.
- Always use proper and good-quality tools.

### 6.1 Preventive Maintenance

- Regularly clean and lubricate the bead breaker socket and Duck head ratchet system socket.
- Regularly lubricate the thread of the quick-release screws.



## 6.2 Ordering Parts

Contact Rabaconda® to order spare parts.

When ordering spare parts, you must always have the following information:

- Tool name (Street bike tire changer).
- Date of purchase or order number.
- Your shipping address and phone number for courier service.
- Part name and quantity.

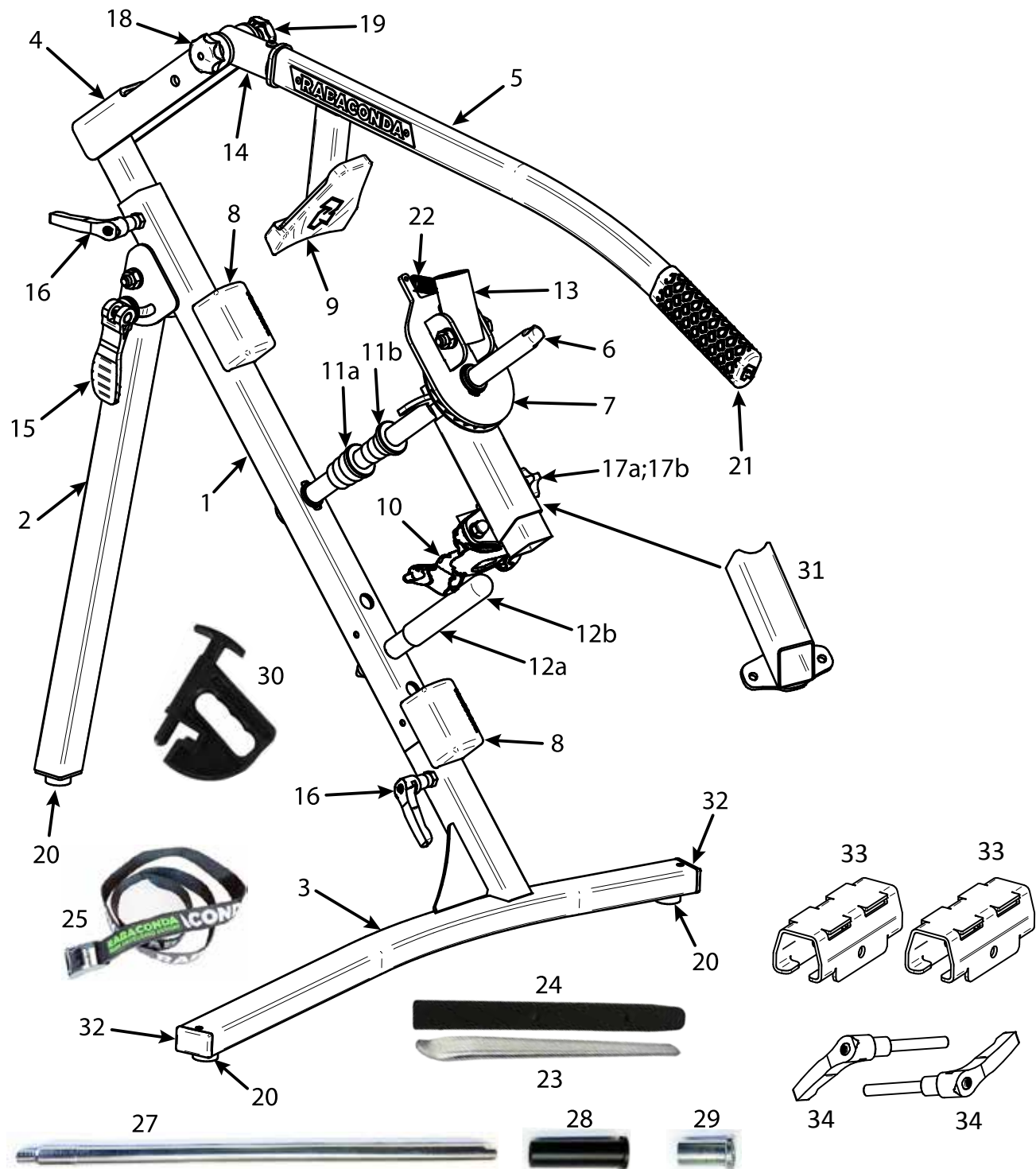

1	Main frame
2	Rear leg
3	Base leg
4	Bead breaker bracket
5	Bead breaker lever
6	20mm center spindle
7	Duck head ratchet system
8	Magnetic wheel supports
9	Bead breaker plastic cover
10	Standard Duck head
11a	Stepped bushing 22-25mm
11b	Stepped bushing 28-32mm
12a	Stopper pin (including rubber cover)
12b	Rubber cover for stopper pin
13	Ratchet system socket
14	Bead breaker socket
15	Cam lever
16	Quick release screw

17	Duck head knob screw
18	Bead breaker knob screw
19	Bead breaker knob nut
20	Rubber leg pad
21	Hand grip
22	Spring
23	Tire iron
24	Tire iron protective plastic cover
25	Strap
26	Carry bag
27	15mm center spindle
28	15mm ratchet system bushing (black)
29	Stepped bushing 17mm-3/4"
30	Drop center tool
31	Standard Duck head mouting arm
32	Rectangular tube cap
33	Wheel support riser clamp
34	Riser clamp screw

## 6.3 Packing, Transport and Storage

### Essential Rules for Transport:

- After use, clean the device from any dirt, bead grease or other stains.
- Disassemble the device and store all parts in the supplied Rabaconda® bag.

### Essential Rules for Safe Storage:

- After use, disassemble the device and store all parts in the supplied Rabaconda® bag.
- Pack with care to avoid damage.
- Store the bag in a dry room.
- Avoid strong solvents or abrasives for cleaning.

## 7 SPARE PARTS AND WEARING PARTS

Always state the correct part name and your original order number/date when ordering parts.

### 7.1 Wearing Parts

Wearing parts are parts that usually wear out first during intentional use.  
For the reliable operation of a tool, it is essential that wearing parts are of high quality.  
Wearing parts are permanently excluded from the warranty.

#### Wearing parts for the Steet Bike Tire Changer:

- Tire iron
- Tire iron plastic cover
- Duck head
- Plastic bead breaker cover
- Magnetic wheel supports
- Rubber cover for rim rotation blocker pin (stopper pin)
- Strap for wire-spoked wheels
- Carry bag
- Hand grip
- Rubber leg pads

Wearing parts are available for purchase at [rabaconda.com](http://rabaconda.com) or by email [sales@rabaconda.com](mailto:sales@rabaconda.com)

### 7.2 List of Consumables

- Bead grease
- Bead grease brush

## 8 SPECIFICATIONS

- Suitable for 12 - 21" wheels.
- Wheel hub diameter: 15 - 32 mm.
- Special adaptors for single-sided swing arms and large wheel hubs.
- Shipping weight: 41 lbs (18.4 kg).
- Net product weight (incl. carry bag): 37 lbs (17 kg)
- Materials:
  - Galvanized steel frame;
  - Plastic mounting head, wheel supports, and bead breaker cover.
- Carry-bag dimensions: 29 x 11 x 10 inches (73 x 28 x 26 cm).
- Shipping cardboard box dimensions: 31 x 11.5 x 8 inches (80 x 29 x 21cm).

## 9 FAQ

### Do I need to remove brake disc/rotor?

- No, you do not need to remove the rotors. The supports below the rim are adjustable, so you can slide them as wide as necessary to accommodate any size brake disc. In case the rim rotation blocker pin cannot be inserted, use the provided strap instead.

### Does it balance the wheel?

- No, but you can use Rabaconda® Motorcycle Wheel Balancer for balancing your wheels. It takes only a few minutes per wheel to balance. There are also other handy solutions like balancing beads, Ride-On tire balancing liquid, Centramatic wheel balancers, etc.

### What is the smallest axle diameter?

- The smallest axle diameter that the tool can be used for is 15mm. The 15mm spindle kit is included.

### Does it work on single-side swingarms?

- Yes, we have special adapters available as optional accessories. Our goal is to offer accessories for the tire changer so you can use it for all makes and models of bikes. It is easy with double-sided swing arms - the tire changer comes with a stepped spacers that aligns the wheel on the center spindle. Single-sided swingarm wheels vary between different bike models and need a different approach. We have suitable adapters for most bike types in our range of optional accessories.

### Does it work with wire-spoked wheels?

- The Street Bike Tire Changer is designed predominantly for cast wheels, but it also works with the wire-spoked wheels. In the case of wire-spoked wheels, instead of the stopper pin to lock the wheel from rotating, a strap (provided with the tire changer) through the spokes should be used. Positioned right next to the rim, it blocks the wheel from rotating as needed when changing a tire. However, proper cautiousness is always required as using excessive force can still damage a spoke. Please follow our instructions in this manual for the correct useage of the strap.

### What about the tire iron?

- After testing several different shapes and lengths of tire irons, we have found the best one to accompany this tire changer. The tire changer includes the tire iron, so you can just roll up the sleeves. We have even included a protective cover for the tire iron to provide maximum protection for your rims.

### What if I don't have a suitable adapter?

- If the free play gets over 4-5 mm between the hub and the adapter, reach out to us and we will do our best to provide a solution.

## What if I use very stiff sidewall tires?

- Changing stiff sidewall tires will require more time, patience, extra care, drop center tools, and skills. Do not use excessive force, and take your time to develop the proper technique. Follow the instructions provided in this manual. Warming up the tire before change does magic.

## Can I change dirt bike tires with the Street Bike Tire Changer?

- Yes, dirt bike tires can be changed with it. If you have a rimlock on your dirt bike wheel, you should incorporate an extra layer of precaution and awareness when navigating the rim lock. However, it is probably faster with good quality tire irons and the Rabaconda® Dirt Bike Tire Changer.

## Can it be used with foam inserts (bib-mousses)?

- No, you can't use a duck head to change tires with bib mousse inserts. Instead, use Rabaconda® Dirt Bike Tire Changer and the Pro Tire Iron Set.

# 10 WARRANTY

## 10.1 Warranty Provisions

Rabaconda® guarantees the proper functioning of the provided equipment. However, Rabaconda® is not responsible for unsafe situations, accidents, or damage, which are the result of:

- Ignoring warnings and regulations as stated in this Operator's manual.
- The use of the device for other applications or under other circumstances than stated in this documentation.
- Mutations to the machine include the application of different replacement parts as specified.
- Insufficient or careless maintenance.

## 10.2 Limited Warranty

This warranty is effective from 20 July 2023 and replaces all previous warranty terms issued by Rabaconda®. All previous warranty terms are null and void.

Lifetime warranty for manufacturer defects. It does not cover wear parts of the product. The duck head, wheel support blocks, bead breaker cover, stopper pin cover, strap, bag, and tire iron with plastic cover are wear parts; the lifetime warranty does not cover them.

Surface finish is not guaranteed as the products are considered tools, and contact points will cause normal wear. Colors, patterns, and finishes are deemed cosmetic only and may vary. Damage of an aesthetic nature such as varnish, enamel, lacquer, paint and damage due to corrosion or the gradual deterioration of the machine is not covered.

Rabaconda® is not responsible for and will not warranty products that show obvious misuse, alteration, or abuse. You agree that Rabaconda® is the sole judge of determinations regarding such misuse, alteration, or abuse.

Warranties on structural steel parts of Rabaconda® products vary depending on the model and date of

purchase.

Guarantees apply only to original purchasers and are not transferable. In the case of direct purchase from the factory, the product is automatically registered at the time of sale by the buyer(s). For products purchased from authorized dealers, the original invoice from that authorized dealer must be presented.

Evidence of purchase is required for all warranty claims. Evidence must be in the form of a copy of an original invoice/sales receipt or order confirmation e-mail, showing the date of purchase in the owner's name.

Warranties only apply to Rabaconda® products and parts. Third-party products, such as rims, tires, wheels, and spokes, are not covered by the guarantee.

The ratchet system is covered for the life of the original tool, provided there is no evidence of misuse, abuse, alteration, or overloading.

Shipment of products for warranty claims from the customer to Rabaconda® and from Rabaconda® to the customer is the buyer's responsibility.

Rabaconda® reserves the right to revise, amend, modify or withdraw the terms of this warranty policy at any time and for any reason.

Rabaconda reserves the right to determine whether to honor or deny a warranty as it deems appropriate based solely on the objective judgment of Rabaconda® specialists.

## 10.3 Liability

Rabaconda® can't be held liable for consequential damage (business interruption, product damage, etc.).

**CHANGE TIRES IN NO TIME – WHENEVER  
YOU NEED IT.**



**FOLLOW US  
FOR THE LATEST  
TIRE CHANGE TIPS**



**RABACONDA**