

Technische Daten: Art.-Nr.: 528 110

Wandaußenmaß: 260 x 220 cm

Bohlenstärke: 28 mm



Kontrolliert durch:

Achtung: Alle angegebenen Maße sind ca.-Maße!

3D-Darstellung Art.-Nr. 528 110

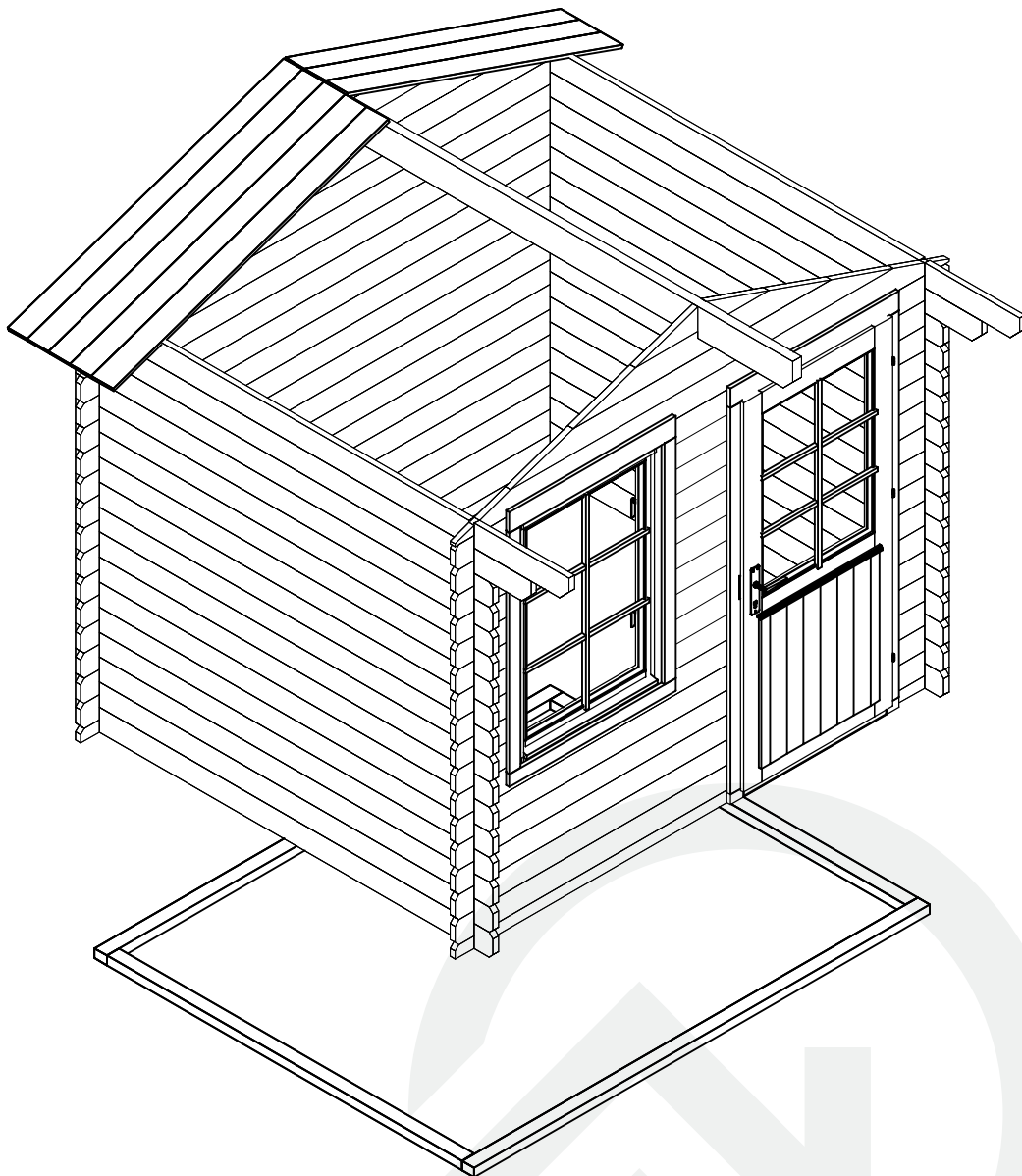

Grundriss Art.-Nr. 528 110

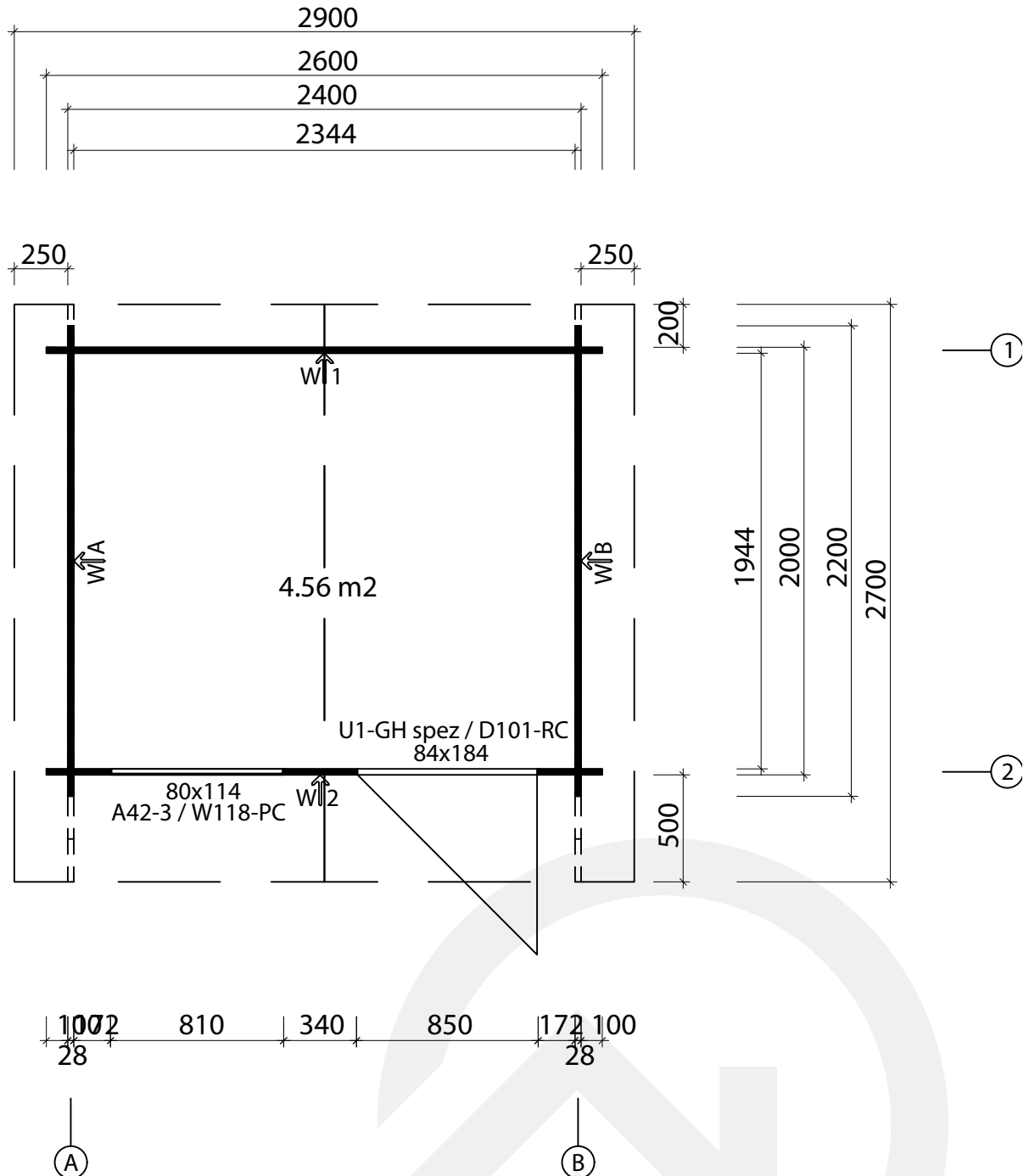

Q2-Qualitätsklasse für Fenster und Türen/

* Fenster und Türen sind mit Sprossen

Lagerholzplan und Fundamentplan Art.-Nr. 528 110

Wir empfehlen als Fundament für Ihr Gartenhaus eine vollflächig festgegründete, gepflasterte oder betonierte Fläche.
Wahlweise ist auch ein Punkt- oder Streifenfundament möglich.

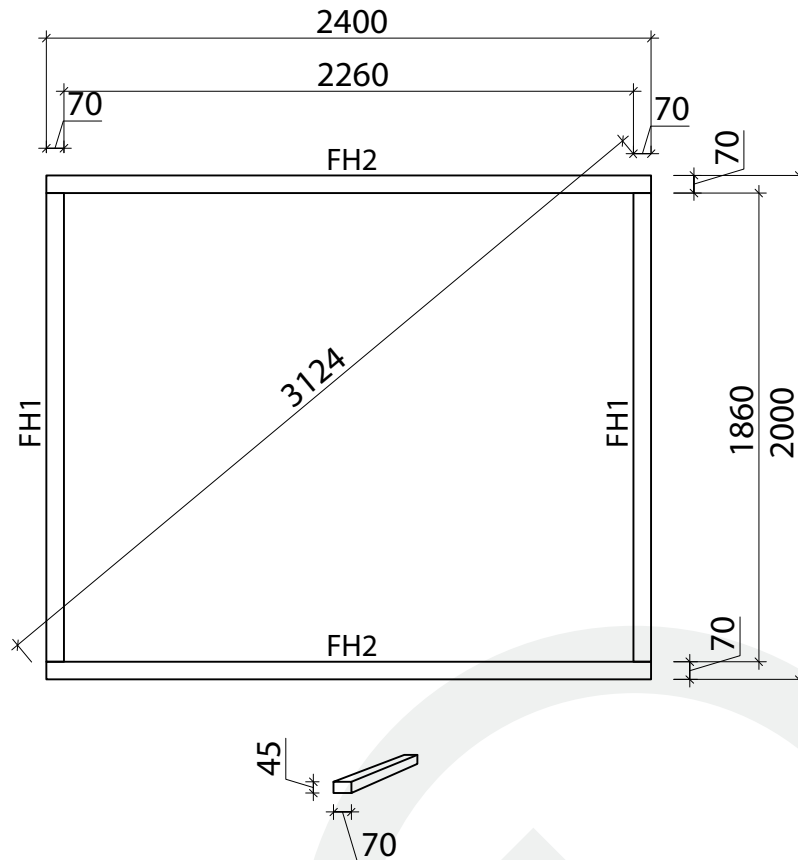



Teileliste 1

Art.-Nr. 528 110

Pos		Stck	Profil (mm)	Länge (mm)
001		1	28x114	2700
002		1	28x114	2700
003		1	28x57	2600
004		16	28x114	2600
006		2	28x114	2400
007		30	28x114	2200
009		1	28x57	1450
010		1	28x114	1450
011		5	28x114	1450
013		10	28x114	340
016		26	28x114	300
017		1	28x57	300
W1-1		1		
W2-1		1		
FH2	FUNDAMENTHÖLZER (imprägniert) 	2	70x45	2400
FH1	FUNDAMENTHÖLZER (imprägniert) 	2	70x45	1860
PF1	PFETTEN 	1	44x145	2700
	DACHBRETTER	48+1	113x16	1535
G02-1	GIEBELBRETT 18x120 19,1° ✓	4	18x120	1615
G06-1	GIEBELDECKLEISTEN 18x58 ✓	4	18x58	1615
T06-1	TRAFENLEISTEN 18x40	2	18x40	2700
T07-1	TRAFENLEISTEN 18x58	2	18x58	2700
GS	Giebelsegment	2		

Teileliste 2

Artikel-Nr.: 528 110

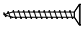
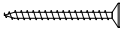
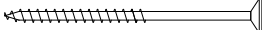
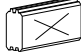
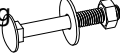
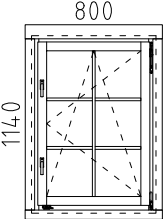
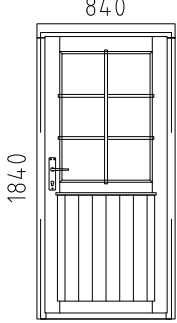
Pos		Stck	Profil (mm)	Länge (mm)
SM-1	Sturmleisten 	4	18x40	1824
NG04	NÄGEL 2.5x50 Dachbretter 	192		
SR32	SCHRAUBEN 3.0x30 Traufenleiste 40x18 	12		
SR37	SCHRAUBEN 3.5x45 Giebelleisten, Giebelbretter Traufenleiste 58x18, Giebelsegment 	48		
SR57	SCHRAUBEN 5.0x100 Fundamenthölzer 	16		
SH	Schlaghölzer 	3		
SS03	Schloßschrauben M8x60 Mutter M8 U-Scheibe Ø25 - Befestigung für Sturmleisten 	12		
	Q2 FENSTER W2-S28P-06C-08001140	1		
	 800 1140 A42-3 / W118-PC			
	Q2 TÜR D2-S28R-56C-08401840	1		
	 840 1840 U1-GH Spez / D101-RC DIN rechts			
	✓ - bitte selber anpassen (falls nötig)!			

Wandplan 1 Art.-Nr. 528 110

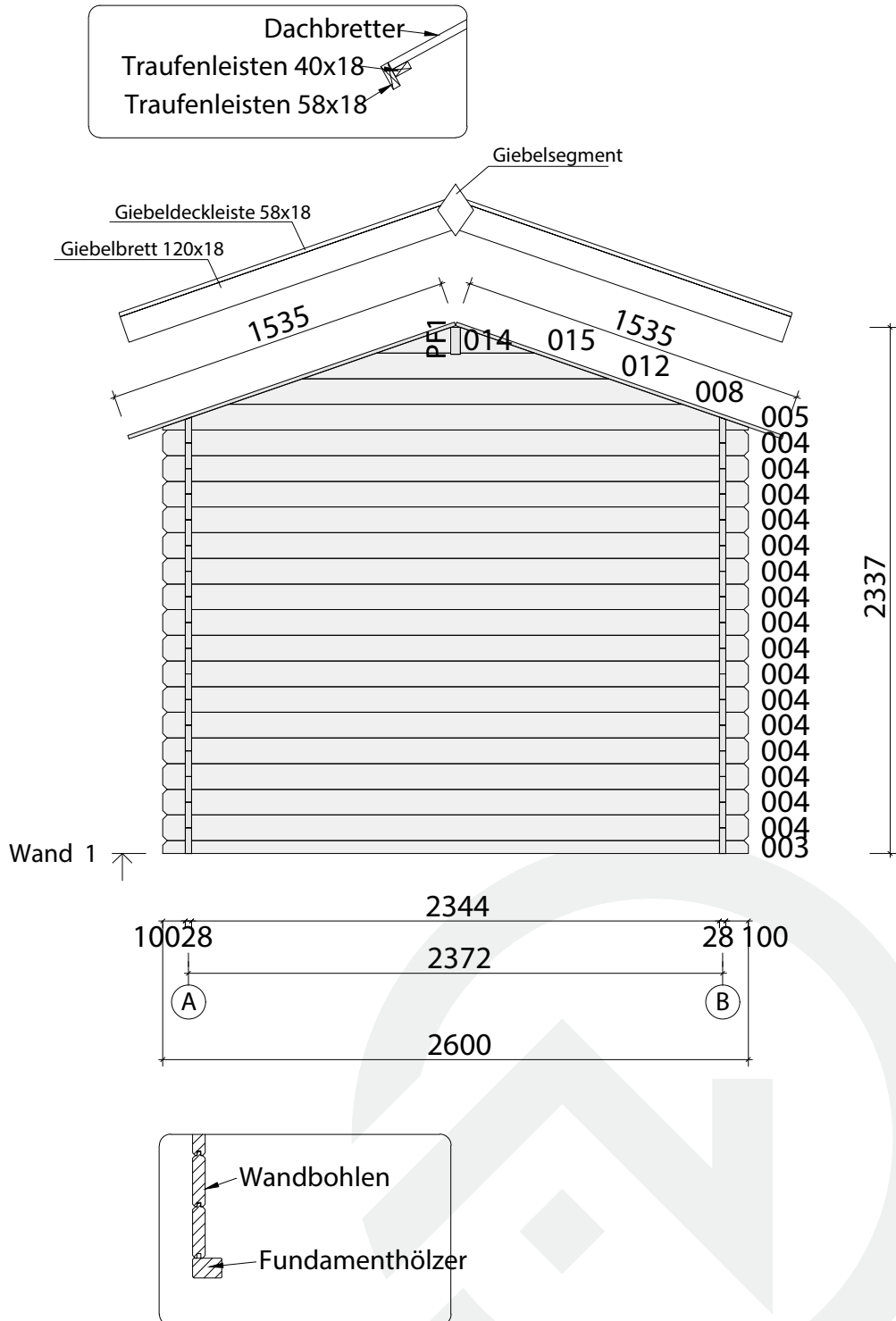

Wandplan 2 Art.-Nr. 528 110

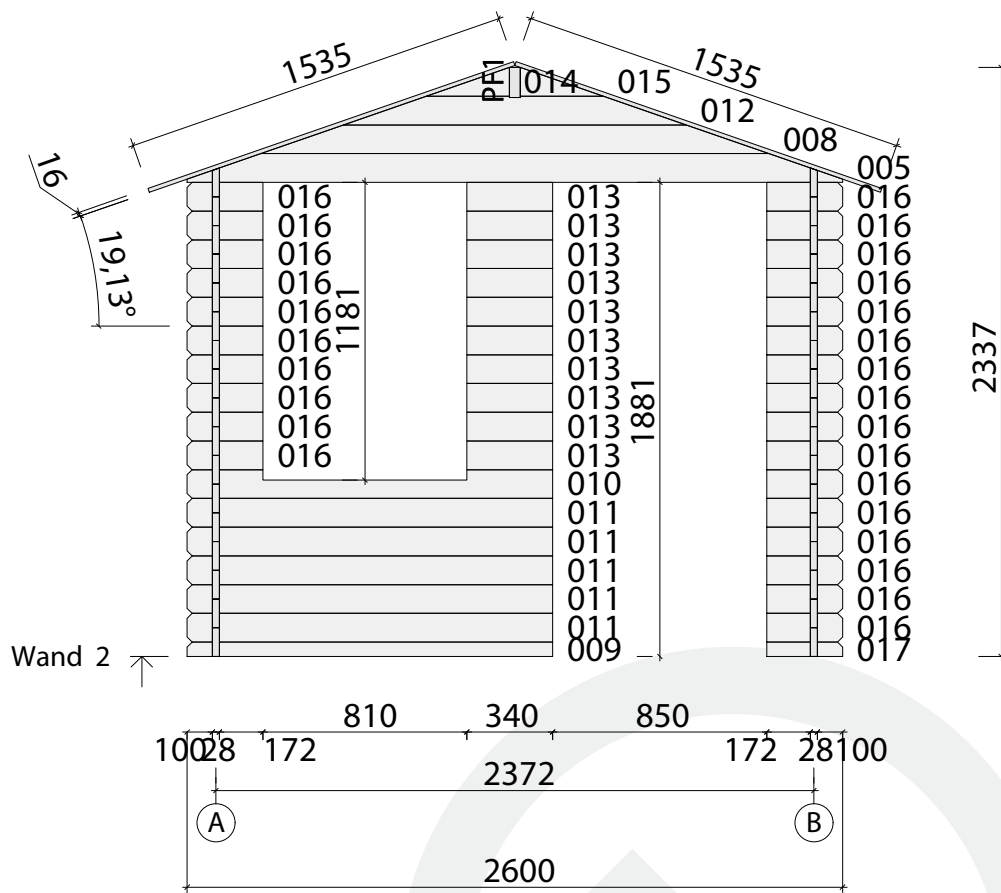

Wandplan A

Art.-Nr. 528 110

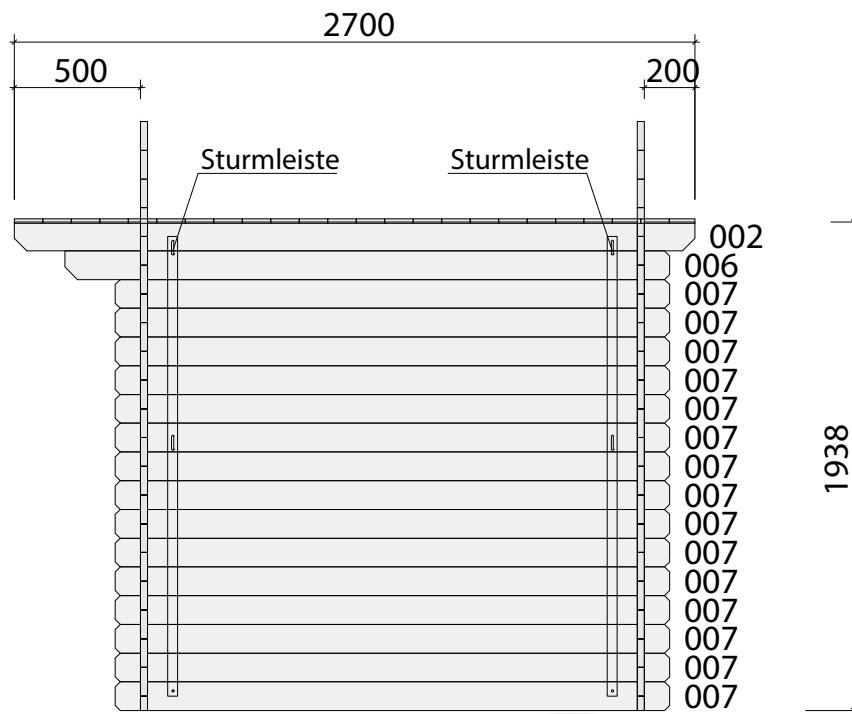
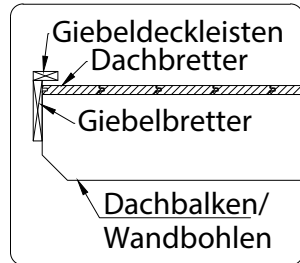

Wand A ↗

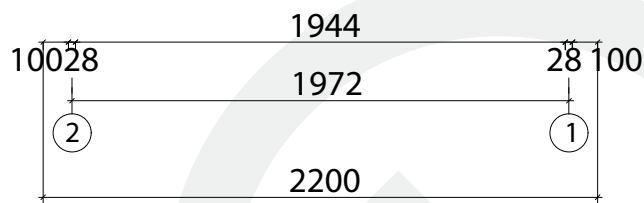

Wandplan B

Art.-Nr. 528 110

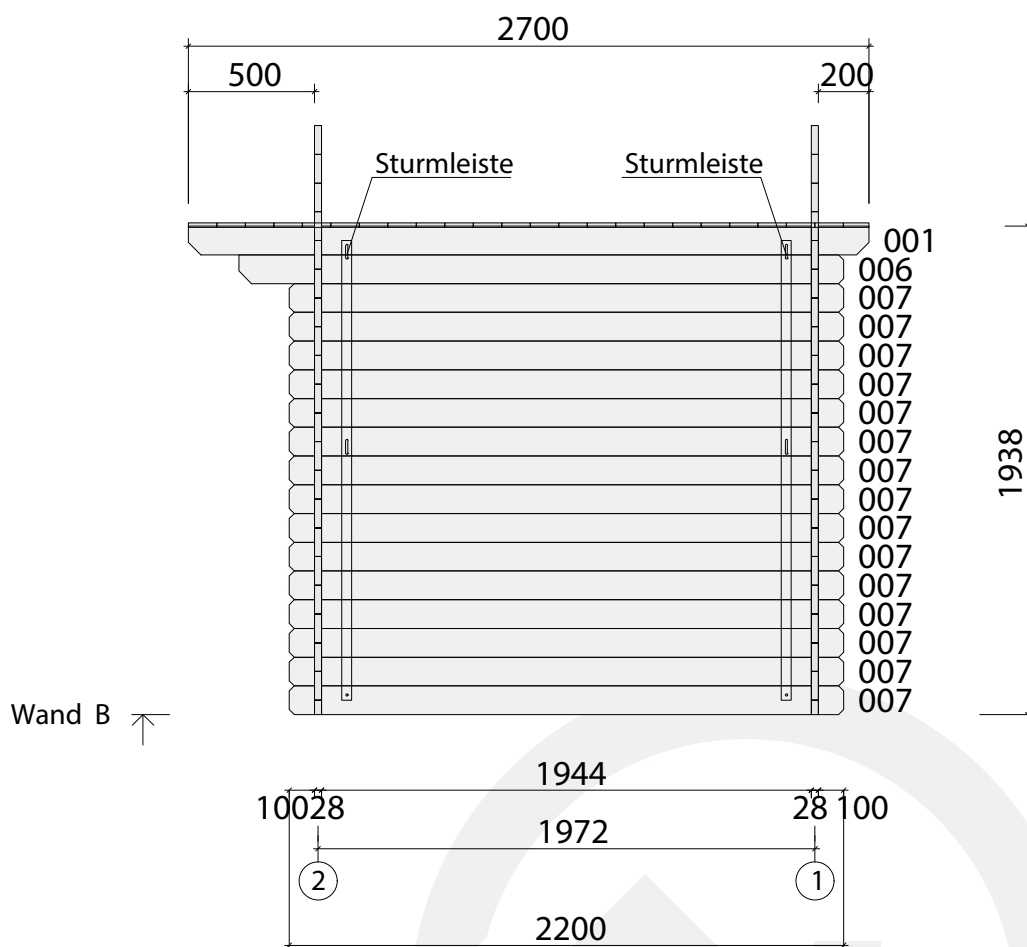

Türmontage

Art.-Nr. 528 110

Uks Q2-Q3 - koostamisjuhised
 Door Q2-Q3 - assembly instructions
 Tür Q2-Q3 - Montageanleitung

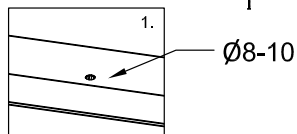
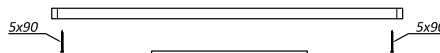
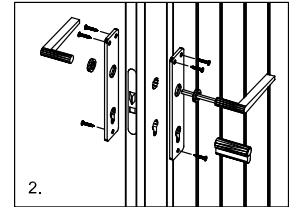
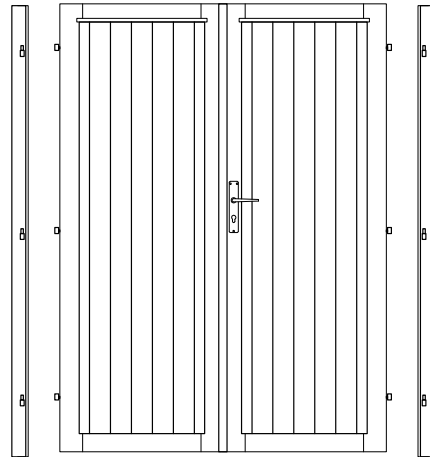
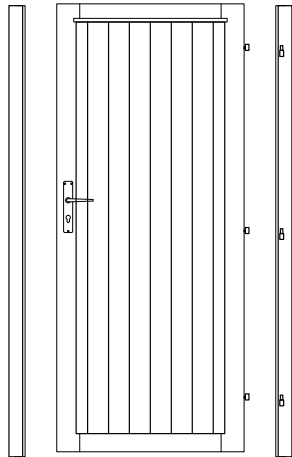
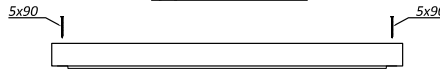
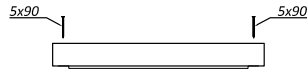
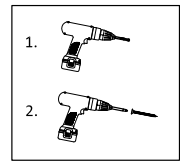
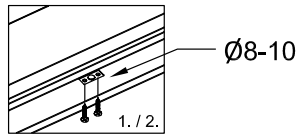

*Kui hinged ei ole paigaldatud!
 *When hinges are not attached!
 *Wenn Scharniere sind nicht angebracht!

*Kui ühepoolne uks ei ole kokku pandud!
 *When single door is not assembled!
 *Wenn Einzeltür ist nicht zusammengebaut!

